

SLAB NOTE SOG-1
 5" MIN. NORMAL WEIGHT CONCRETE SLAB-ON-GRADE REINFORCED WITH #4@15" OC EACH DIRECTION. PLACE ON 15 MIL VAPOR BARRIER OVER 6" CRUSHED STONE SUBBASE ON COMPACTED SUBGRADE. SAW CUT CONTROL JOINTS AT 8'-0" OC MAX. SPACING

- PLAN NOTES:**
- PN1. SEE PLAN FOR TOP OF CONCRETE ELEVATION.
 - PN2. [X'-X"] INDICATES BOTTOM OF FOOTING ELEVATION.
 - PN3. P# ON PLAN INDICATES PIER AND PILASTER TYPE. SEE S200 FOR TYPE DETAILS.
 - PN4. SAW-CUT CONTROL JOINTS IN SLAB-ON-GRADE AT ALL COLUMN CENTERLINES AND AT MID-BAYS. RE-ENTRANT CORNERS ARE PROHIBITED.
 - PN5. GEOTECHNICAL ENGINEER MUST APPROVE ALL FOOTING BASES PRIOR TO CONCRETE PLACEMENT.
 - PN6. CONSULT ENGINEER OF RECORD (EOR) IF FIELD CONDITIONS REQUIRE ELEVATION CHANGES IN EXCESS OF 1'-0".

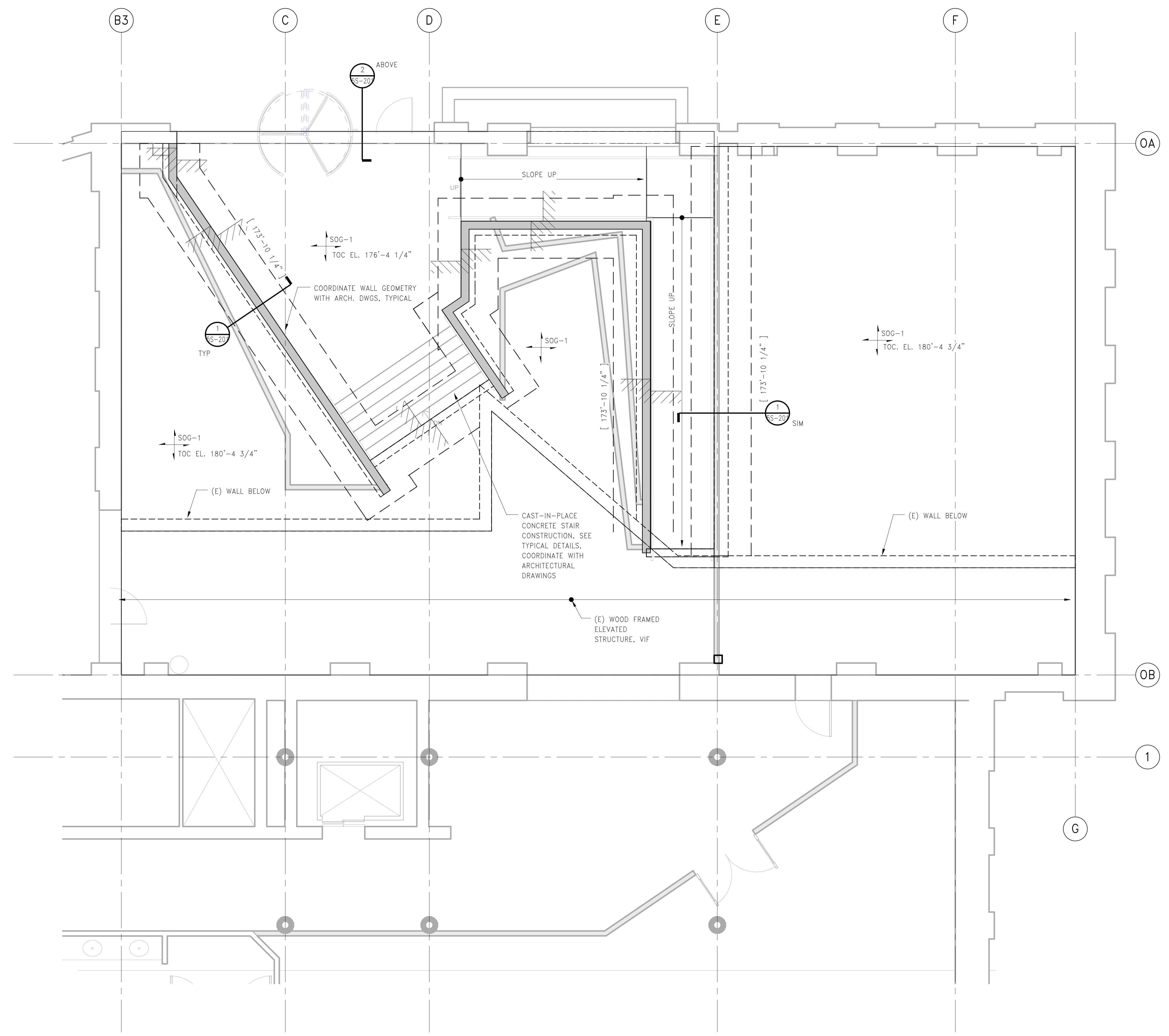

LEVEL 1 NORTH LOBBY FRAMING PLAN
 1/4" = 1'-0"

MPA MARGULIES PERRUZZI ARCHITECTS
 388 Congress Street | Boston, MA 02210 | 617.482.2322 | www.mpa-architects.com
 Design for the way you work.

CLIENT INFORMATION
AS CLOCK TOWER
 OWNER, LLC c/o
 SARACEN
 PROPERTIES
 MILL & MAIN
 RENOVATION
 PHASE 1
 146 MAIN STREET
 MAYNARD, MA 01751

CONSULTANT INFORMATION

MEP ENGINEERS
 CHASE CONSULTING ENGINEERS
 24 HARVARD AVE., 3RD FLOOR
 BOSTON, MA 02108
 781.572.5200

STRUCTURAL ENGINEER
 SIMPSON GIMPERTZ & HEGER
 41 SEYON STREET, BLDG 1, SUITE 500
 WALTHAM, MA 02153
 781.951.9026

MECHANICAL ENGINEERS
 KALIN ASSOCIATES
 100 WASHINGTON ST., #2
 BOSTON, MA 02109
 617.964.5177

ELECTRICAL ENGINEERS
 SLADEN FEINSTEIN INTEG.
 250 WASHINGTON AVE., # 305
 BOSTON, MA 02108
 617.267.9500

LANDSCAPE DESIGN
 BROWN, RICHARDSON, & ROWE
 800 WASHINGTON ST., 3RD FLOOR
 BOSTON, MA 02109
 617.542.8852

GEOTECHNICAL CONSULTANT
 HALEY & ALDRICH, INC.
 405 MEDFORD STREET, SUITE 2000
 BOSTON, MA 02129
 617.856.7591

REVISIONS

NUMBER	DESCRIPTION	DATE

STAMP

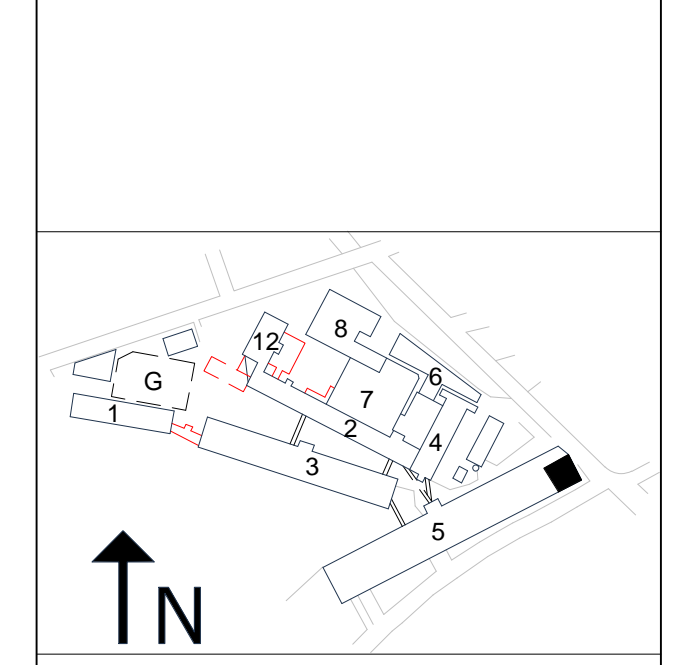

KEY PLAN
 DATE: 10/19/15
 SCALE: 1/4" = 1'-0"
 DRAWN BY: MSS
 PROJECT NUMBER: SAR15A.00
 DRAWING TITLE
LEVEL 1 - NORTH LOBBY FRAMING PLAN

5S-101
 DRAWING NUMBER