

- PLAN NOTES:**
- PN1. DECKING: 6"x1" IPE BOARD SPANS PERPENDICULAR TO THE JOISTS.
 - PN2. SEE ARCHITECTURAL AND LANDSCAPE DRAWINGS FOR ELEVATIONS AND SLOPES.
 - PN3. SEE LANDSCAPE DRAWINGS FOR CABLE GUARDRAIL SYSTEM.
 - PN4. ALL WOOD FRAMING IS PRESSURE TREATED.
 - PN5. ALL STEEL AND CONNECTORS ARE EITHER HDG OR STAINLESS STEEL AS NOTED IN SECTIONS AND DETAILS.
 - PN6. SEE DETAIL 6 ON 3S-600 FOR GIRDER SPLICE DETAIL.
 - PN7. PROVIDE CONTINUOUS 4"x10" BLOCKING AT MIDSPAN OF JOISTS. FASTEN WITH HDG U410 HANGERS BY SIMPSON STRONGTIE.
 - PN8. REFER TO 3S/600 FOR LIGHT POLE SUPPORT DETAILS.

BOARDWALK AND PIER FRAMING PLAN
 1/16" = 1'-0"

MPA MARGULIES PERRUZZI ARCHITECTS
 308 Congress Street | Boston, MA 02210 | 617.482.2327 | www.mpp-architects.com
 Design for the way you work.

CLIENT INFORMATION
 AS CLOCK TOWER
 OWNER, LLC c/o
 SARACEN
 PROPERTIES
 MILL & MAIN
 RENOVATION
 PHASE 1
 146 MAIN STREET
 MAYNARD, MA 01751

CONSULTANT INFORMATION

MECH ENGINEERS
 KALIN ASSOCIATES
 22 HARTWELL AVE., SUITE 202
 WEST NEWTON, MA 02465
 617.984.5477

CIVIL ENGINEER
 NUSCH ENGINEERING
 2 CENTER PLAZA, SUITE 400
 BOSTON, MA 02108
 617.542.8552

LANDSCAPE DESIGN
 BROWN, RICHARDSON, & ROWE
 100 STATE ST., SUITE 300
 BOSTON, MA 02109
 617.542.8552

GEOTECHNICAL CONSULTANT
 HALEY & ALDRICH, INC.
 485 MEDFORD STREET, SUITE 200
 MEDFORD, MA 02155
 617.882.7299

STRUCTURAL ENGINEER
 SIMPSON GUMPERTZ & HEGGER
 41 SEYON STREET, BLDG 1, SUITE 500
 BOSTON, MA 02116
 781.902.0000

HARDWARE CONSULTANT
 CAMPBELL-MCCABE, INC.
 100 STATE ST., SUITE 300
 BOSTON, MA 02109
 781.899.8822

LIGHTING CONSULTANTS
 SLADEN FENSTEIN INTEG.
 100 STATE ST., SUITE 300
 BOSTON, MA 02109
 617.527.9950

REVISIONS		
NUMBER	DESCRIPTION	DATE

STAMP

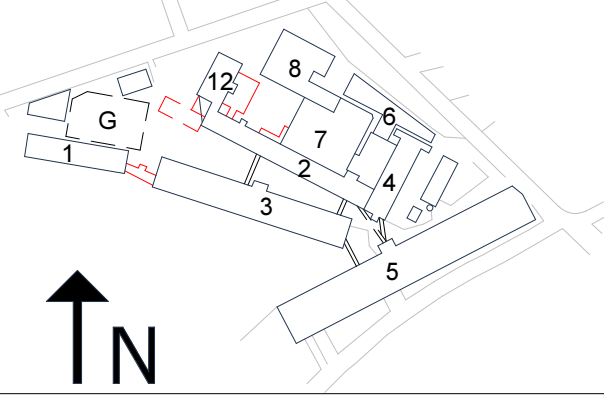

KEY PLAN
 DATE: 10/19/2015
 SCALE: 1/16" = 1'-0"
 DRAWN BY: MAT
 PROJECT NUMBER: SAR15A.00
 DRAWING TITLE
**BOARDWALK AND PIER
 FRAMING PLAN**

3S-100A
 DRAWING NUMBER