

1 BUILDING 7 - PLUMBING WEST ENTRY DEMOLITION PLAN
1/8" = 1'-0"

MPA MARGULIES PERRUZZI ARCHITECTS
308 Congress Street | Boston, MA 02210 | 617.482.2327 | www.mpp-architects.com
Design for the way you work.

CLIENT INFORMATION
MILL & MAIN NEW ENTRY OF BLDG 7
146 MAIN STREET
MAYNARD, MA 01754

CONSULTANT INFORMATION

MEP ENGINEERS
AHA CONSULTING ENGINEERS
24 HARTWELL AVE., 3RD FLOOR
LEWINGTON, MA 02421
www.aha-engineers.com

CIVIL ENGINEER
NISCH ENGINEERING
2 CENTER PLAZA, SUITE 400
BOSTON, MA
TEL: 617.338.6683 - www.ritcheng.com

LANDSCAPE DESIGN
BROWN, RICHARDSON, & ROWE
100 STATE ST., 11TH FLOOR
BOSTON, MA 02109
TEL: 617.542.8532 - www.browntowe.com

OWNER
AS CLOCK TOWER OWNER LLC
11 SECON ST, SUITE 200
MAYNARD, MA 02148
TEL: 781.250.8000 - www.asclocktower.com

HARDWARE CONSULTANT
CAMPBELL-MCCABE, INC.
111 MAIN ST., SUITE 100
MAYNARD, MA 01754
TEL: 781.899.8822 - www.campmcc.com

STRUCTURAL ENGINEER
SIMPSON GUMPERTZ & HEGGER
100 STATE ST., SUITE 500
BOSTON, MA 02109
TEL: 781.502.9000 - www.sgh.com

GEOTECHNICAL CONSULTANT
HALEY & ALDRICH, INC.
445 MEDFORD STREET, SUITE 2000
MEDFORD, MA 02155
TEL: 617.886.7399 - www.haleyaldrich.com

REVISIONS		
NUMBER	DESCRIPTION	DATE

STAMP

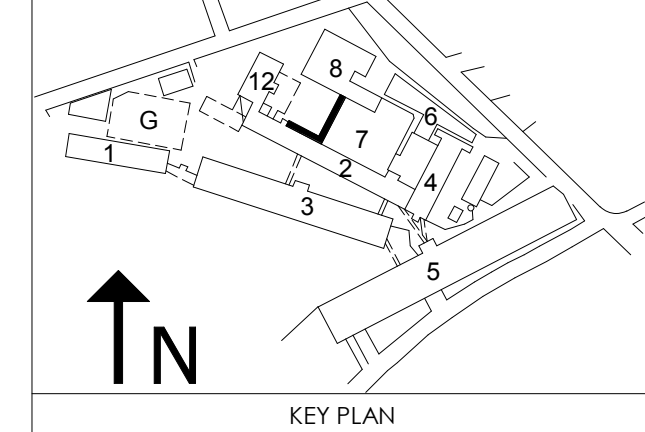

DATE.....10/19/2015
SCALE.....1/8" = 1'-0"
DRAWN BY.....DLR
PROJECT NUMBER.....SAR15A.00
DRAWING TITLE
PLUMBING WEST ENTRY DEMOLITION PLAN
7PD-100
DRAWING NUMBER