

1 BUILDING 7 - FIRE ALARM WEST ENTRY DEMOLITION PLAN  
1/8" = 1'-0"

**MPA** MARGULIES PERRUZZI ARCHITECTS  
308 Congress Street | Boston, MA 02210 | 617.482.2327 | www.mpa-architects.com  
Design for the way you work.

CLIENT INFORMATION  
**MILL & MAIN NEW ENTRY OF BLDG 7**  
146 MAIN STREET  
MAYNARD, MA 01754

CONSULTANT INFORMATION  
**MEP ENGINEERS**  
**NISSCH ENGINEERS**  
 24 HARTWELL AVE., 3RD FLOOR  
 BOSTON, MA 02421  
 TEL: 617.338.6683 - www.nitcheng.com  
**LANDSCAPE DESIGN**  
**BROWN, RICHARDSON, & ROWE**  
 100 STATE ST., 11TH FLOOR  
 BOSTON, MA 02109  
 TEL: 617.542.8532 - www.browntowe.com  
**GEOTECHNICAL CONSULTANT**  
**HALEY & ALDRICH, INC.**  
 445 MEDFORD STREET, SUITE 2000  
 MEDFORD, MA 02155  
 TEL: 617.886.7399 - www.haleyaldrich.com  
**OWNER**  
**AS CLOCK TOWER OWNER LLC**  
 11 SECON ST., SUITE 200  
 BOSTON, MA 02109  
 TEL: 781.250.8000 - www.asclocktower.com

REVISIONS		
NUMBER	DESCRIPTION	DATE

STAMP

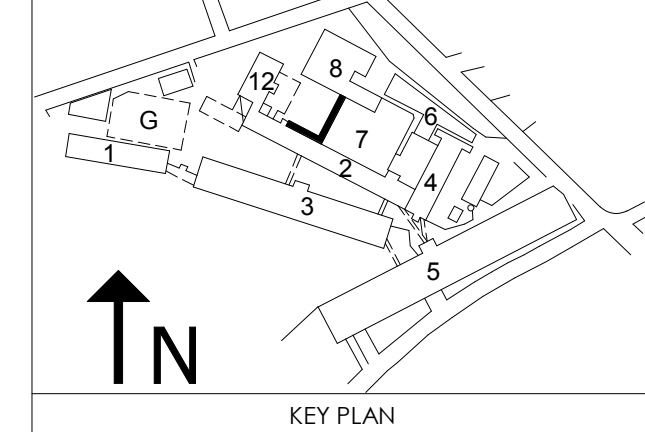

KEY PLAN  
DATE: 10/19/2015  
SCALE: 1/8" = 1'-0"  
DRAWN BY: DLR  
PROJECT NUMBER: SAR15A.00  
DRAWING TITLE  
**FIRE ALARM WEST ENTRY DEMOLITION PLAN**  
**7FAD-100**  
DRAWING NUMBER