

MILL POND

PROGRESS 10/1/2015

Nitsch Engineering
 www.nitscheng.com
 2 Center Plaza, Suite 430
 Boston, MA 02108
 T: (617) 338-0063
 F: (617) 338-6472

- ▶ Civil Engineering
- ▶ Land Surveying
- ▶ Transportation Engineering
- ▶ Structural Engineering
- ▶ Green Infrastructure
- ▶ Planning
- ▶ GIS

BORDERING VEGETATED WETLAND/BANK AS FLAGGED BY IEC ENVIRONMENTAL CONSULTANTS ON SEPTEMBER 4TH AND 22, 2015. FLAGS SURVEYED/LOCATED BY NITSCH ENGINEERING.

BORDERING VEGETATED WETLAND/BANK AS FLAGGED BY IEC ENVIRONMENTAL CONSULTANTS ON SEPTEMBER 4TH AND 22, 2015. FLAGS SURVEYED/LOCATED BY NITSCH ENGINEERING.

FEMA FLOOD ZONE AS ELEVATION 179' (NAVD88) DATED JULY 7, 2014. PERIMETER #250703362.

THE LOWER AND UPPER SUDBURY PARKING LOTS WERE PREVIOUSLY SURVEYED BY ANOTHER COMPANY. NITSCH ENGINEERING, INC. DOES NOT CERTIFY TO THE ACCURACY OR COMPLETENESS OF THE AREAS SURVEYED BY OTHERS.

MASSACHUSETTS STATE PLANE COORDINATE SYSTEM
 NAD 83

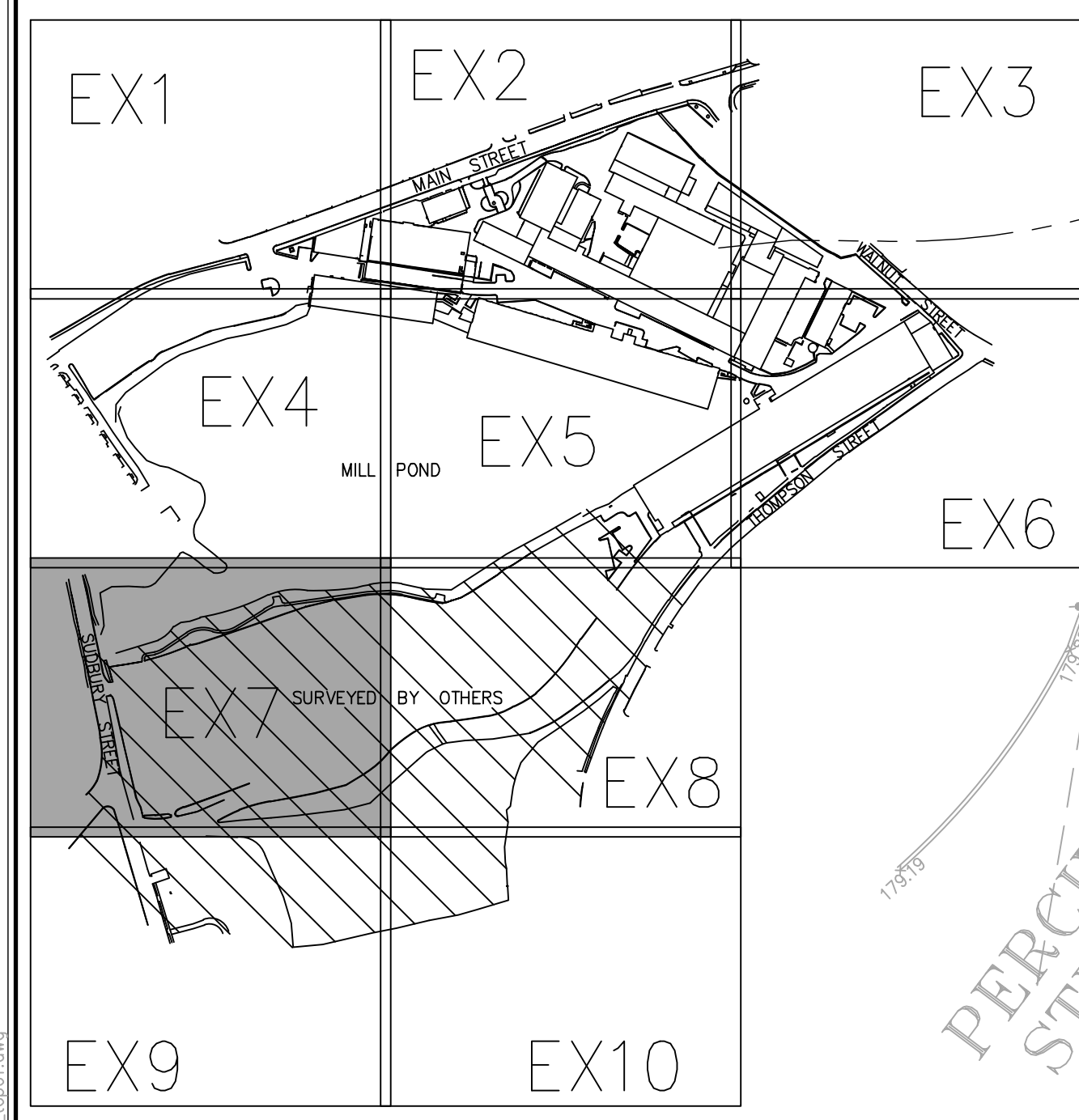
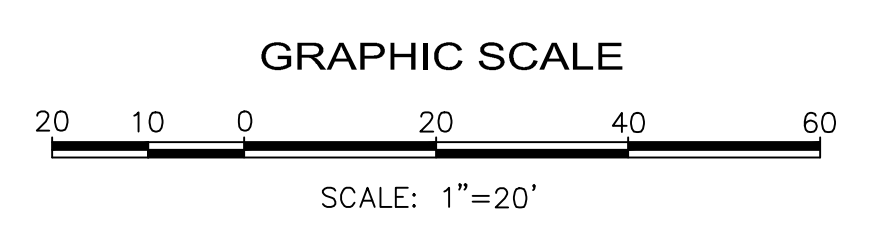

SHEET KEY
 NOT TO SCALE
 NOTE: SEE SHEET EX1 FOR NOTES AND LEGEND.

TOPOGRAPHIC PLAN
 MAYNARD MILL
 MAYNARD, MASSACHUSETTS

PREPARED FOR:
SARACEN PROPERTIES, LLC
 41 SEYON STREET, SUITE 200, WALTHAM, MASSACHUSETTS 02453

REV.	COMMENTS	DATE

PROJECT # 11009.1
 FILE: 11009.1_TOP01.dwg
 SCALE: 1"=20'
 DATE: OCTOBER 1, 2015
 DES./COMP: RGM
 FIELD BOOK: 61B
 DRAFTED BY: PAR
 CHECKED BY:
 SHEET:
EX7
 OF 10 REV.